

No.	Part Name
1	Body
2	Disc
3	Disc Retainer
4	Disc Seat
5	Body Seat
6	Body Seat Gasket
7	Disc Seal Gasket
8	Shaft
9	Disc Pin
10	Shaft Bearing
11	Thrust Bearing
12	Packing
13	Packing Gland
14	Gland Flange
15	End Cap
16	End Gasket
17	Bracket

Test Pressure(Psi-G) API 598		
	Hydraulic	Air
Shell	450	325
Seat	325	90
Seat	90	90

TOP WORKS

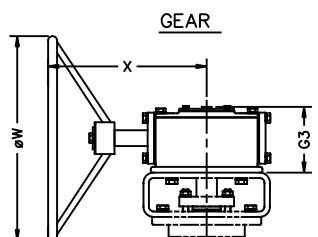
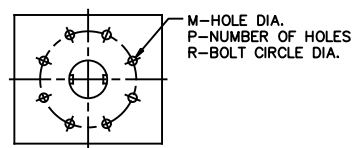

SIZE (inch)	A	B	G1	G2	E1	L1	L2	C	T	FLANGED DRILLING						TOP WORKS				KEY	GEAR			
										WAFER		LUG		FLANGE		M	P	R	S		G3	X	øW	
										N1	N2	H1	N2	N1	N2					H2				
26	21.46	21.85	5.51	4.53	31.89	6.50	11.50	31.75	1-1/4"X8UN	-	4	-	24	20	4	1-3/8	0.83	8	11.73	2.76	0.79 X 0.47	6.18	19.92	27.95
28	22.84	22.83	6.30	4.53	33.66	6.50	11.50	34.00	1-1/4"X8UN	-	4	-	28	24	4	1-3/8	1.22	8	14.02	3.15	0.87 X 0.55	8.15	23.82	31.50
30	23.23	24.21	6.30	5.12	35.63	7.48	12.52	36.00	1-1/4"X8UN	-	4	-	28	20	8	1-3/8	1.22	8	14.02	3.35	0.98 X 0.55	8.15	23.82	31.50
32	24.61	25.20	6.30	5.12	36.62	7.48	12.52	38.50	1-1/2"X8UN	-	4	-	28	20	8	1-5/8	1.50	8	15.98	3.54	0.98 X 0.55	9.29	24.92	35.43
34	27.36	27.17	6.30	5.12	38.59	7.99	12.99	40.50	1-1/2"X8UN	-	4	-	32	24	8	1-5/8	1.50	8	15.98	3.94	1.10 X 0.63	9.29	24.92	35.43
36	27.56	28.35	7.09	5.91	41.35	7.99	12.99	42.75	1-1/2"X8UN	-	4	-	32	24	8	1-5/8	1.50	8	15.98	3.94	1.10 X 0.63	9.29	24.92	35.43
40	28.74	29.92	7.09	6.30	43.31	8.50	16.14	47.25	1-1/2"X8UN	-	4	-	36	28	8	1-5/8	1.50	8	15.98	4.33	1.26 X 0.71	9.29	24.92	35.43
42	32.09	30.31	7.09	6.30	43.70	9.49	16.14	49.50	1-1/2"X8UN	-	8	-	36	28	8	1-5/8	1.50	12	19.02	4.33	1.26 X 0.71	10.83	32.32	39.37
46	35.04	33.07	7.09	6.30	46.46	10.00	18.50	53.75	1-1/2"X8UN	-	8	-	40	32	8	1-5/8	1.50	12	19.02	4.72	1.26 X 0.71	10.83	32.32	39.37
48	35.43	36.22	7.87	7.87	51.96	10.00	18.50	56.00	1-1/2"X8UN	-	8	-	44	36	8	1-5/8	1.50	12	19.02	5.51	1.42 X 0.79	10.94	36.18	31.50

NOTE.  
 1. DESIGN : ANSI B16.34 & API 609  
 2. FLANGE CONNECTION : ANSI B16.47 SERIES A CLASS 150 (MSS SP-44 CLASS 150)  
 3. FACE TO FACE DIMENSION :  
 WAFER , LUGGED TYPE -  
 26"-32" 36" 40" 48" - ISO 5752 SHORT  
 34" 42" 46" - MANUFACTUTER STD  
 FLANGED TYPE -  
 26"-32" 36"-42" 48" -EIGHTH EDITION API 609 CATEGORY B (ISO 5752 SERIES 13)  
 34" 46" - MANUFACTUTER STD

File No. TP150WLF2648\_03  
 Scale NOT TO SCALE  
 Date of Issue 2015-10-23  
 Title TRIPLE OFFSET VALVE 150# WAFER, LUGGED & FLANGED TYPE  
 DWG No. TP150WLF2648-03  
 Drawn by Kim,S.S  
 Checked by Byeon,J.S  
 Approved by Choi,J.Y  
 No. \_\_\_\_\_  
 Date \_\_\_\_\_  
 Revision \_\_\_\_\_

**PRATT INDUSTRIAL**

THE INFORMATION CONTAINED IN THIS DRAWING IS THE SOLE PROPERTY OF PRATT INDUSTRIAL. ANY REPRODUCTION IN PART OR AS A WHOLE WITHOUT THE WRITTEN PERMISSION OF PRATT INDUSTRIAL IS PROHIBITED.